

# F45 PARTS LIST

## F45 MAIN ASSEMBLY

Part #	Part #	Description	Part #	Part #	Description
Australia	New Zealand		Australia	New Zealand	
1)	590-513	560058 Louver Assembly Bottom	36)	936-194	Starter Collar/Air Passage Gasket
2)	590-514/P	556160 Louver Assembly Top	37)	*	Flue Collar/Starter Collar Gasket
3)	651-135	n/a Door Screen (Aust. only)	38)	820-058	556062 Pedestal Bottom Cover Plate
5)	910-199	Wire Holder Clip	39)	*	Air Passage/Transition Box Gasket
6)	910-179	Snap Bushing			
7)	910-006	560062 Terminal Block		948-117	551867 Masport Logo
9)	621-550	556161 Relief Door Assy (with Gasket)			
10)	621-042	556162 Gasket for Relief Door			
	620-598/P	556179 Fan Assembly			
11)	910-155/P	560023 Fan Motor			
12)	910-714	560061 Power Cord			
13)	910-178	Grommet for Power Cord			
	910-889	Wire Harness (stove conn. end)			
	910-716	560063 Wire Harness (fan connection end)			
15)	*	Pedestal Assembly			
16)	650-138	560228 Pedestal Door			
17)	904-257	551893 Pedestal Door Magnet			
18)	590-126	556165 Pedestal Back			
19)	590-541	560005 Side Panel Door Assy (Left Side)			
20)	650-527	556058 Side Panel Door Hinge Bkt (Left)			
21)	590-542	560071 Side Panel Door Assy (Right Side)			
22)	650-528	556059 Side Panel Door Hinge Bkt (Right)			
23)	904-258	551891 Side Panel Door Magnet			
24)	948-241	560135 Door Latch			
27)	910-233	560065 Thermodisc - Fan Auto/On/Off			
28)	650-086	560066 Mounting Bracket - Fan Thermodisc			
30)	620-019	556166 Rear Panel			
31)	923R	Direct Vent Adapter			
32)	591-187	Firebox Baffle			
33)	621-525	556142 False Top Assembly			
34)	620-051	556158 Flue Restrictor #1			
35)	621-052	Flue Restrictor #2			

\*Not available as a replacement part.

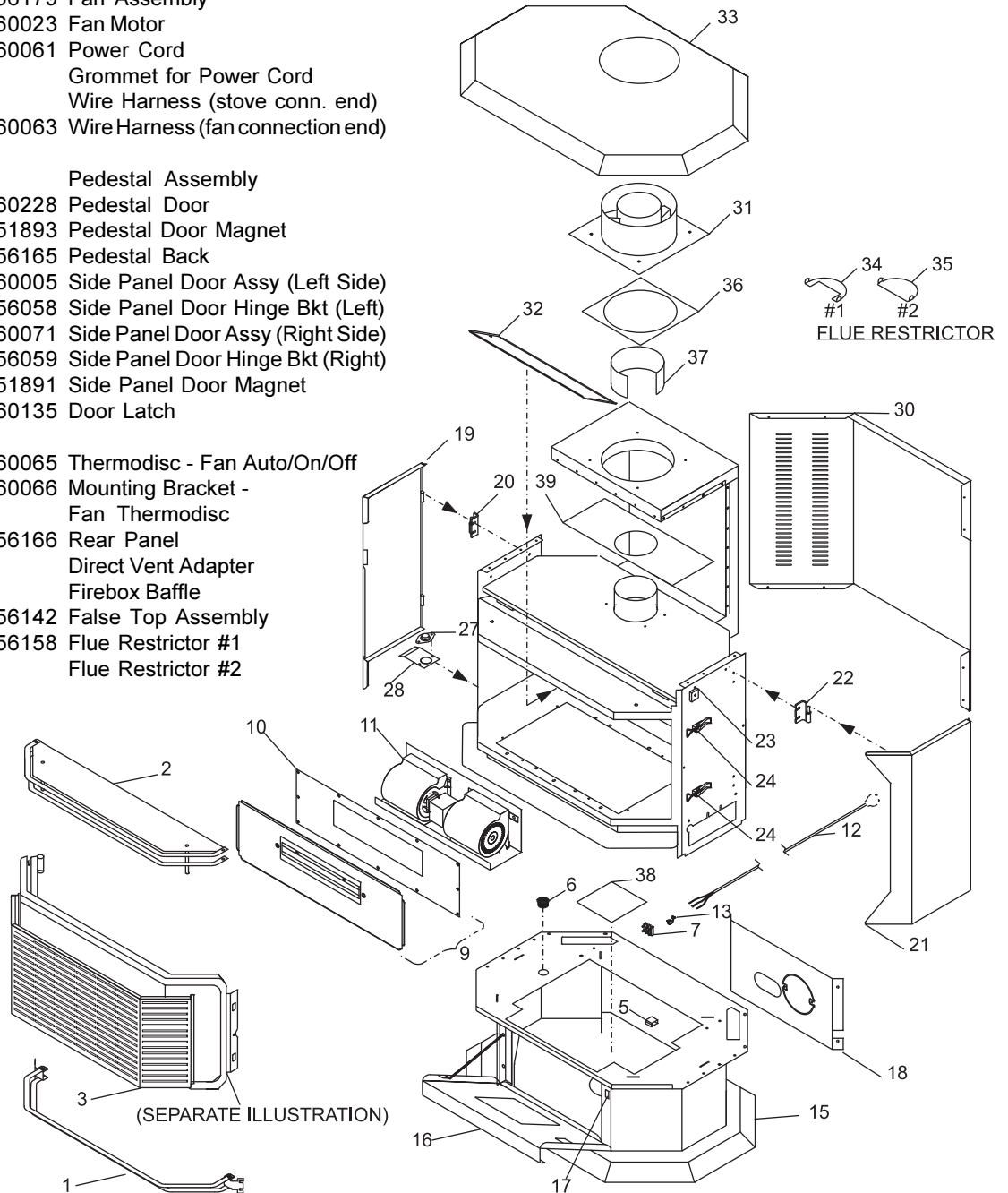

# F45 PARTS LIST

## F45 BURNER & LOG ASSEMBLIES

Part #	Part #	Description	Part #	Part #	Description
Australia	New Zealand		Australia	New Zealand	
51)	910-246	560024 Burner ON/OFF Switch (3-way)	75)	650-933	560047 Pkg. Log Set
52)	910-190	597004 Piezo Ignitor & Nut			
53)	910-140	560036 Fan HI/OFF/LOW switch	77)	936-191	Burner Tray Gasket
54)	910-373	588412 Knob - Pilot Valve Extension	78)	936-192	Burner Tray/Air Passage Gasket
55)	910-372	588413 Flame Adjusting Knob	79)	651-578	556066 Burner Assy-NG
56)	908-057	Control Panel Decal	80)	651-575	556067 Burner Assy -LP
57)	591-041	Control Panel Plate			
	621-581/P	Valve Assembly - Natural Gas			
	621-582/P	Valve Assembly - Propane			
60)	910-378	588394 Valve S.I.T. - Natural Gas			
	910-380	588405 Valve S.I.T. - Propane			
	904-688	556172 #32 Orifice - N.G.			
	904-163	560192 #54 Orifice - Propane			
	904-241	551852 #56 Orifice - Propane			
	936-170	556174 Gasket for Orifice (NG/LP)			
72)	910-022	556117 Pilot Assy 3 flame - N.G.			
	910-025	556080 Pilot Assy 4 flame - Propane			

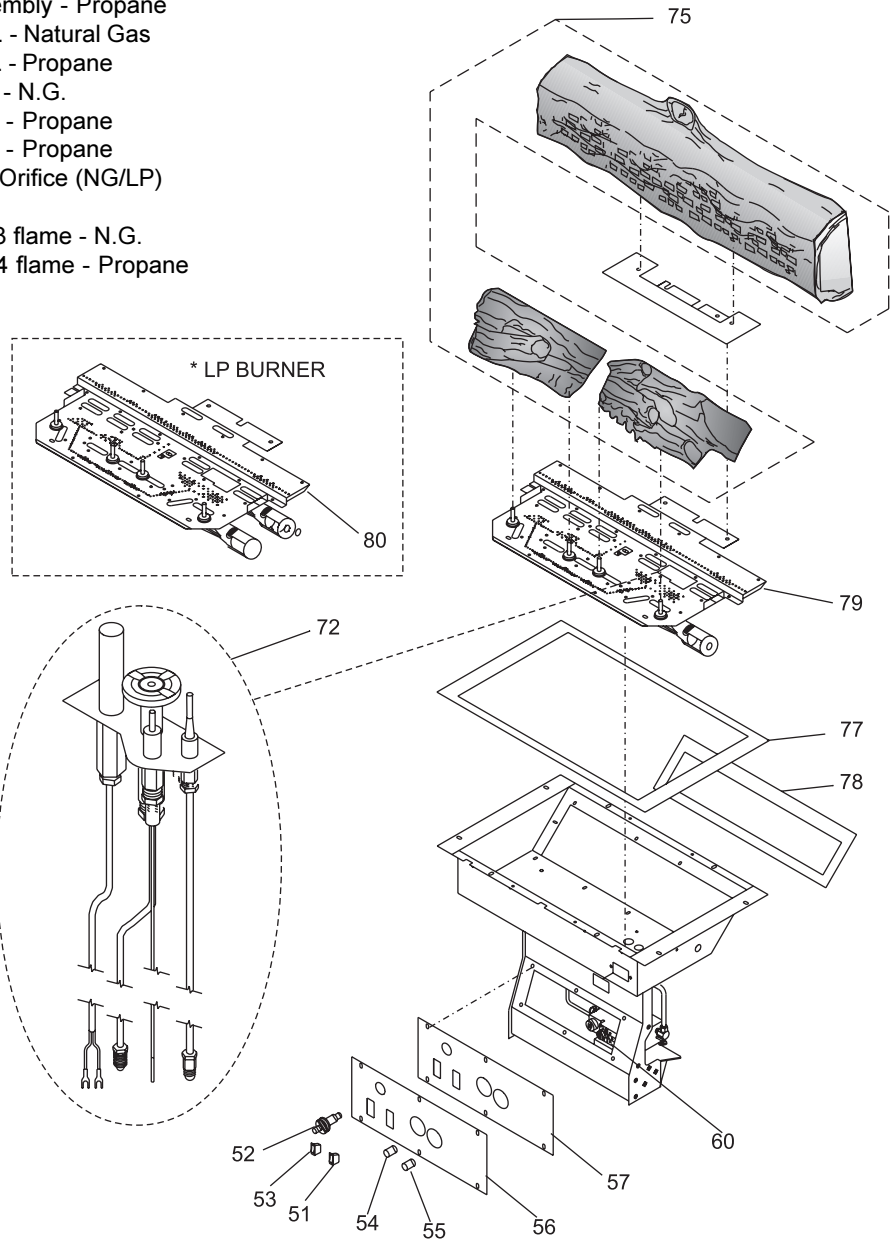

## F45 DOOR ASSEMBLIES

Part #	Part #	Description
<b>Australia</b>	<b>New Zealand</b>	
650-975		Gold Mitred Door - Complete
650-974	556122	Black Mitred Door - Complete
101)	846-570	560018 7/8" Door Gasket Repair Kit
103)	590-190	Glass Retainer Side
104)	*	Glass Retainer Side - Top/Bottom
105)	*	Glass Retainer Front
106)	940-226/P	560222 Side Glass
107)	936-243	560087 Glass Gasket
108)	940-227/P	560039 Mitred Centre Glass
112)	650-236	560269 Door Glass Extrusion
114)	*	556178 Ceramic Paper 1/16" x 3/4"

\*Not available as a replacement part.

